

过滤器用污染堵塞发讯器

订购码



CS-IV

-

0.35

产品型号

发讯值

见下表

 CS-IV CS-III
 CM CM-I
 CY-I CY-II
 YM-I CYB-I
 CMS ZS-I
 ZKF-II

注:CYB-I型与ZKF-II型,只适用于DC24V,2A,不能与计算机配套使用。

例:CS-III-0.35 ZS-10.018

技术参数

型 号	工作压力 (MPa)	发讯值 (MPa)	工作温度 (°C)	发讯器功率
CM-I CM CS-III CMS CS-IV	32	0.1+0.05 0.2+0.05 0.35+0.05 0.5+0.05	-20~+80	≤ 220V 0.25A
CY-I CY-II YM-I	1.6	0.6+0.05 0.8+0.05		
CYB-I		0.35+0.05		DC 24V 2A
ZS-I ZKF-II	-0.9	-0.01~0.018 -0.018		≤ 220V DC 24V 2A

外形尺寸

P1:高压腔

P2:低压腔

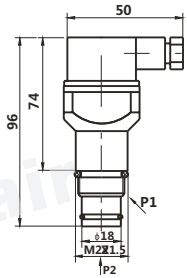

CS-III

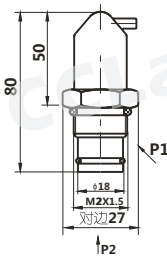

CS-IV

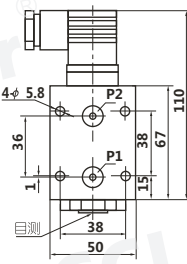

CM

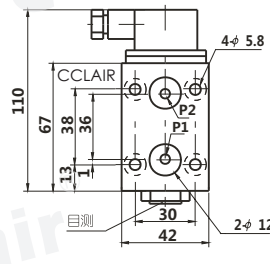

CMS

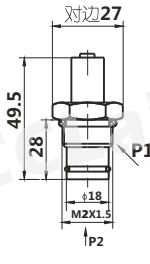

CM-I

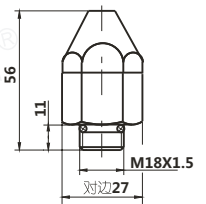

YM-1

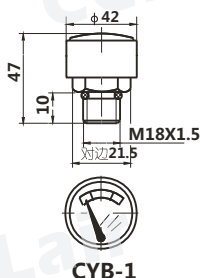

CYB-1

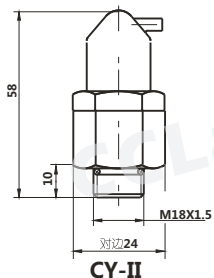

CY-II

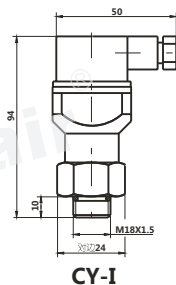

CY-I

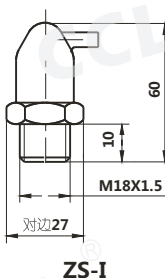

ZS-I

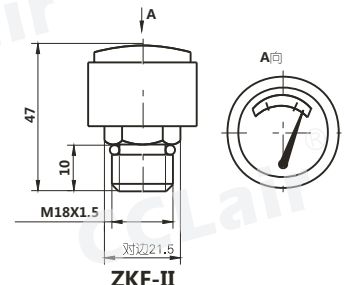

ZKF-II